



# TILT T

Luminaire design: Eclatec

**TILT "ORIGIN"** opened the road to medium height lighting in a refined style; this pioneer is essential when mounting on top of the pole is required and it therefore remains available in its original design.

Added to this original luminaire, the new **TILT T** range applies, with its four models, the arguments of top or lateral mounting, thanks to a reversible sleeve and also the argument of modularity and easy intervention.

In effect, the four luminaires in the **TILT T1, T2, T3 and T4** range accept an easily interchangeable **PADLED** module and are designed to facilitate rapid access to the equipment.

The nominal flux range scales from 2,000 lm up to 28,000 lm.

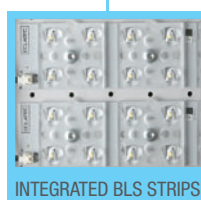
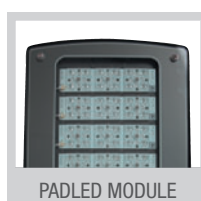



Tilt T on Gem bracket



Tilt T on curved pole



Tilt T on Chrome bracket





TILT T1



TILT T2



TILT T3



TILT T4



## APPLICATIONS

- Mounting: top, bitop and side entry
- Recommended heights: Tilt T1: 4 to 6 m / Tilt T2: 6 to 8 m / Tilt T3: 7 to 10 m / Tilt T4: 7 to 12 m
- Tilt T1: Pedestrian areas, cycle paths, residential areas, street lighting  
Tilt T1/ T2/T3: Roads, secondary urban and inter-urban streets

## DESCRIPTION

- Luminaire available in 4 sizes: Tilt T1, Tilt T2, Tilt T3 and Tilt T4
- body and cover made of injected die-cast aluminium
- Polyester powder coating, any colour available
- IP 66
- IK 09
- Class I or II
- **PADLED** modules equipped with BLS with **QUADRALENS** lenses and bowl in thermally toughened and printed glass
- Colour temperature: 4000 K and 3000 K

## CITIZEN REFERENCE POINTS

- Tilt T1: Aluminium 65%, Glass 13%, Other 16%, Steel 5%, Plastic 1%
- Tilt T2: Aluminium 63%, Glass 17%, Other 13%, Steel 6%, Plastic 1%
- Tilt T3: Aluminium 62%, Glass 19%, Other 13%, Steel 5%, Plastic 1%
- Tilt T4: Aluminium 68%, Glass 23%, Plastic 6%, Steel 2%, Other 1%
- Complies with the RoHS directive
- High recyclability rate

## WATERPROOFING

- IP 66 waterproofing in accordance with the standard EN 60 529
- Extruded silicone gasket
- Cable gland
- Breathing system with activated carbon filter

## MECHANICAL INTERFACES

- **Top 60 and Top 76:** post top fastening Ø 60 mm and Ø 76 mm {1}, male bracket fastening for Ø 60 mm {2}
- **L60 and L76:** side female for Ø 60 mm and Ø 76 mm {3}
- **LL54:** side male mounting for Ø 60 mm steel bracket {4} (see page 278 - F)
- **LL48:** side male mounting for Ø 60 mm aluminium bracket {4} (see page 278 - E)
- Tilts: Top: 0°, 5°, 10° and 15°, Side: 0°, -5°, -10° and -15°



Female fitting for steel and aluminium bracket



Top male fitting for steel and aluminium bracket

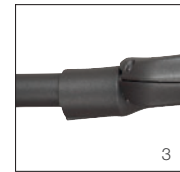

Side female fitting for steel and aluminium brackets



Male fitting for steel and aluminium bracket

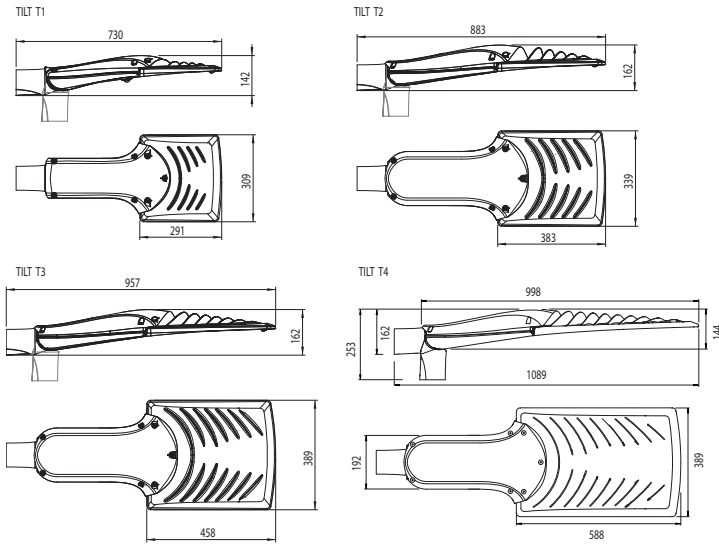

TILT T - ERS

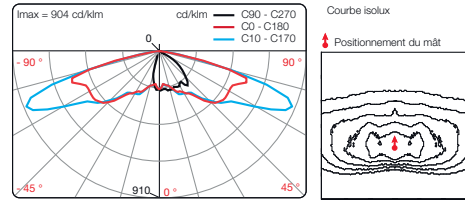

TILT T - LRS

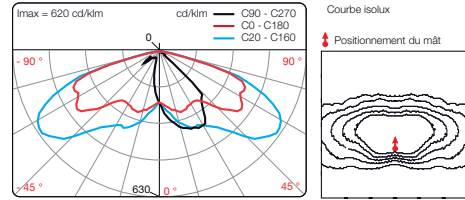

KEY POINTS

		TILT T1	TILT T2	TILT T3	TILT T4
<b>Applications</b>		Pedestrian areas, cycle paths, residential areas, street lighting	Roads, secondary urban and inter-urban streets		
<b>Recommended heights</b>		4 to 6 m	6 to 8 m	7 to 10 m	7 to 12 m
<b>Mounting</b>		See Mechanical interfaces			
<b>Dimensions</b>	<b>Length</b>	730 mm	883 mm	957 mm	998 mm
	<b>width</b>	309 mm	339 mm	389 mm	389 mm
	<b>height</b>	142 mm	162 mm	162 mm	162 mm
<b>Weight</b>		7 kg	10 kg	11,5 kg	13,5 kg
<b>Windage area</b>		0,06 m <sup>2</sup>	0,07 m <sup>2</sup>	0,08 m <sup>2</sup>	0,08 m <sup>2</sup>
<b>Sources</b>		PADLED module (removable) with BLS LED strips			
<b>Sources access</b>		Direct access to the gear after tilting of the canopy			
<b>Optics and light distribution options</b>		QUADRALENS: ERS, ERL, ECa, ERE, ETS, LRS, LRL, EPD, EPG, PFA			
<b>OPTIONS</b>	<b>Backlight shield</b> <sup>(1)</sup> (factory or site assembly)	<input type="radio"/>	<input type="radio"/>	<input type="radio"/>	<input type="radio"/>
	<b>SMART-READY</b> <sup>®</sup> (2) by Eclatec (construction)	<input type="radio"/>	<input type="radio"/>	<input type="radio"/>	-
	<b>DALI</b> (construction)	<input type="radio"/>	<input type="radio"/>	<input type="radio"/>	<input type="radio"/>
	<b>Dimming 5</b> (preset)	<input type="radio"/>	<input type="radio"/>	<input type="radio"/>	<input type="radio"/>
	<b>CLO</b> (preset)	Compatible with standard version, Dimming 5, Motion 5 or DALI option		Compatible with standard version, Dimming 5 or DALI option	
	<b>Motion 5</b> (preset)	<input type="radio"/>	<input type="radio"/>	-	-
	<b>Motion</b> (setting on site)	<input type="radio"/>	<input type="radio"/>	-	-
	<b>Motion COM</b> (setting on site)	-	<input type="radio"/>	-	-
	<b>Motion P</b> (set in the bottom of the pole)	<input type="radio"/>	<input type="radio"/>	<input type="radio"/>	<input type="radio"/>
	<b>POLEDRIVE</b> (set in the bottom of the pole)	<input type="radio"/>	<input type="radio"/>	<input type="radio"/>	<input type="radio"/>

(1) Backlight shield optional except for EPD, EPG, ECa  
 (2) Preconfigured communicating system: Wired Sensor Ready type driver and Zhaga consortium base  
 \* only on versions with 1 or 2 x BLS 8 and by factory programming

Glossary:  
 Standard  Option - Not available

**E/L/P:** Lighting/Luminance/Projection, **R/C/T/F/P:** Road/Circulation/Path/Beam/Pedestrian walkway, **E/S/L/A/D/G:** Narrow/Standard/Wide/Asymmetric/Right/Left, **POLEDRIVE:** preset at the bottom of the pole / night dimming calculator with 2 configurable thresholds, set in the bottom of the pole, **Dimming 5:** night dimming calculator with 5 configurable thresholds, **Motion:** moving sensor, **Motion P:** Configurable offset presence detector at the foot of the pole, **Motion DALI:** Detector integrated to the luminaire, adjustable at pole base, **Motion 5:** Motion sensor and dimming calculator, **Motion COM:** Wireless detection and communication, **DALI:** compatible with the DALI protocol, **CLO:** Constant Lumen Output option

BACKLIGHT SHIELD

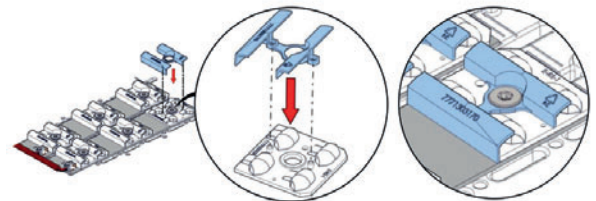

Backlight shield BLS version

MAINTENANCE

Lighting equipment maintenance

Direct access to the equipment after removal of the cover attached by 4 trapped screws {1}. Removable circuit board.

Source maintenance

A second waterproof compartment houses the optical system. Removal of the **PADLED** attached by 3 trapped screws. {2, 3} Electrical disconnection. Removal of the **PADLED** module.





ECLATEC

led verlichting

banken

*afvalbakken*

custom made producten

houten lichtmasten

stalen lichtmasten

*solar verlichting*

lichtzuilen

bandstand

boomroosters

plantenbakken

fietsrekken

*klassieke lichtmasten*

openbare verlichting

terrein verlichting

afzetzpalen

standbeelden

kunst

bollards

fonteinen

Auteursrechten en intellectuele eigendomsrechten

Het auteursrecht op deze brochure berust bij GHM Eclatec B.V. of bij derden (GHM SA en Eclatec SAS) welke met toestemming dit (beeld) materiaal beschikbaar hebben gesteld aan GHM Eclatec B.V. Vermenigvuldiging in wat voor vorm dan ook is alleen toegestaan na voorafgaande toestemming door GHM Eclatec B.V.

Copyright © 2019 GHM Eclatec BV.

Foto credits: ©Eclatec, ©Fotolia, ©Shutterstock, ©GHM

Alle rechten voorbehouden

GHM Eclatec BV Tinstraat 91 2984 AN Ridderkerk 0031 (180) 745043  
info@ghm-eclatec.nl www.ghm-eclatec.nl KVK Rotterdam 53536991

Onderdeel van Agora Technologies