



TILT T

Luminaire design: Eclatec

TILT "ORIGIN" opened the road to medium height lighting in a refined style; this pioneer is essential when mounting on top of the pole is required and it therefore remains available in its original design.

Added to this original luminaire, the new **TILT T** range applies, with its four models, the arguments of top or lateral mounting, thanks to a reversible sleeve and also the argument of modularity and easy intervention.

In effect, the four luminaires in the **TILT T1, T2, T3 and T4** range accept an easily interchangeable **PADLED** module and are designed to facilitate rapid access to the equipment.

The nominal flux range scales from 2,000 lm up to 28,000 lm.

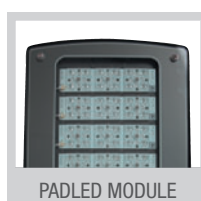

PADLED MODULE

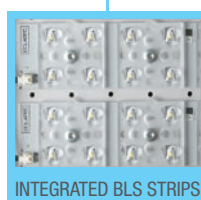

INTEGRATED BLS STRIPS



Tilt T on Gem bracket



Tilt T on curved pole



Tilt T on Chrome bracket



APPLICATIONS

- Mounting: top, bitop and side entry
- Recommended heights: Tilt T1: 4 to 6 m / Tilt T2: 6 to 8 m / Tilt T3: 7 to 10 m / Tilt T4: 7 to 12 m
- Tilt T1: Pedestrian areas, cycle paths, residential areas, street lighting
Tilt T1/ T2/T3: Roads, secondary urban and inter-urban streets

DESCRIPTION

- Luminaire available in 4 sizes: Tilt T1, Tilt T2, Tilt T3 and Tilt T4
- body and cover made of injected die-cast aluminium
- Polyester powder coating, any colour available
- IP 66
- IK 09
- Class I or II
- **PADLED** modules equipped with BLS with **QUADRALENS** lenses and bowl in thermally toughened and printed glass
- Colour temperature: 4000 K and 3000 K

CITIZEN REFERENCE POINTS

- Tilt T1: Aluminium 65%, Glass 13%, Other 16%, Steel 5%, Plastic 1%
- Tilt T2: Aluminium 63%, Glass 17%, Other 13%, Steel 6%, Plastic 1%
- Tilt T3: Aluminium 62%, Glass 19%, Other 13%, Steel 5%, Plastic 1%
- Tilt T4: Aluminium 68%, Glass 23%, Plastic 6%, Steel 2%, Other 1%
- Complies with the RoHS directive
- High recyclability rate

WATERPROOFING

- IP 66 waterproofing in accordance with the standard EN 60 529
- Extruded silicone gasket
- Cable gland
- Breathing system with activated carbon filter

MECHANICAL INTERFACES

- **Top 60 and Top 76:** post top fastening Ø 60 mm and Ø 76 mm {1}, male bracket fastening for Ø 60 mm {2}
- **L60 and L76:** side female for Ø 60 mm and Ø 76 mm {3}
- **LL54:** side male mounting for Ø 60 mm steel bracket {4} (see page 278 - F)
- **LL48:** side male mounting for Ø 60 mm aluminium bracket {4} (see page 278 - E)
- Tilts: Top: 0°, 5°, 10° and 15°, Side: 0°, -5°, -10° and -15°



Female fitting for steel and aluminium bracket



Top male fitting for steel and aluminium bracket

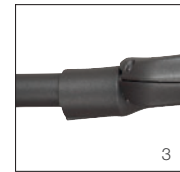

Side female fitting for steel and aluminium brackets



Male fitting for steel and aluminium bracket

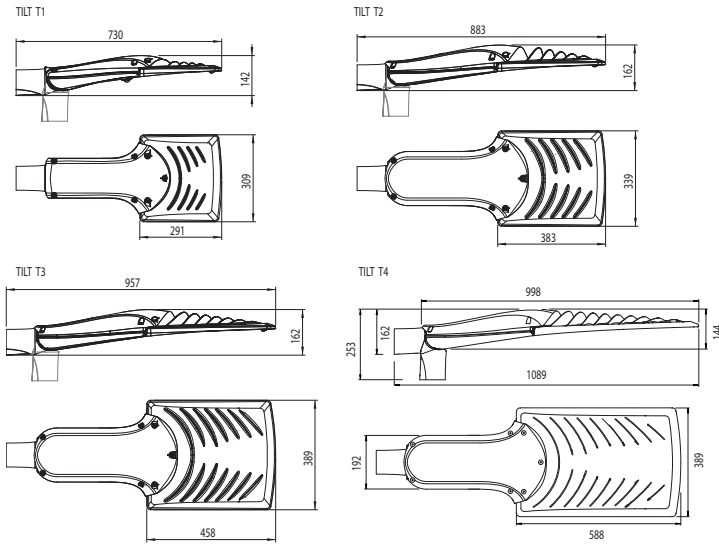

TILT T - ERS

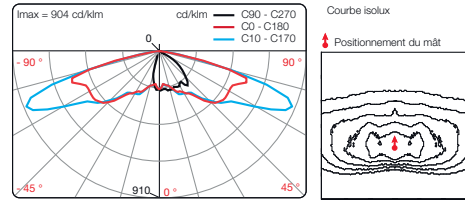

TILT T - LRS

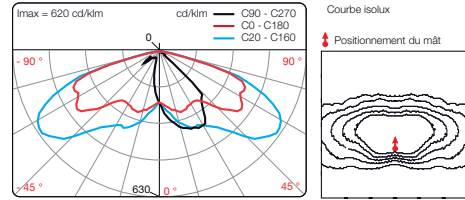

KEY POINTS

		TILT T1	TILT T2	TILT T3	TILT T4
Applications		Pedestrian areas, cycle paths, residential areas, street lighting	Roads, secondary urban and inter-urban streets		
Recommended heights		4 to 6 m	6 to 8 m	7 to 10 m	7 to 12 m
Mounting		See Mechanical interfaces			
Dimensions	Length	730 mm	883 mm	957 mm	998 mm
	width	309 mm	339 mm	389 mm	389 mm
	height	142 mm	162 mm	162 mm	162 mm
Weight		7 kg	10 kg	11,5 kg	13,5 kg
Windage area		0,06 m ²	0,07 m ²	0,08 m ²	0,08 m ²
Sources		PADLED module (removable) with BLS LED strips			
Sources access		Direct access to the gear after tilting of the canopy			
Optics and light distribution options		QUADRALENS: ERS, ERL, ECa, ERE, ETS, LRS, LRL, EPD, EPG, PFA			
OPTIONS	Backlight shield ⁽¹⁾ (factory or site assembly)	<input type="radio"/>	<input type="radio"/>	<input type="radio"/>	<input type="radio"/>
	SMART-READY [®] (2) by Eclatec (construction)	<input type="radio"/>	<input type="radio"/>	<input type="radio"/>	-
	DALI (construction)	<input type="radio"/>	<input type="radio"/>	<input type="radio"/>	<input type="radio"/>
	Dimming 5 (preset)	<input type="radio"/>	<input type="radio"/>	<input type="radio"/>	<input type="radio"/>
	CLO (preset)	Compatible with standard version, Dimming 5, Motion 5 or DALI option		Compatible with standard version, Dimming 5 or DALI option	
	Motion 5 (preset)	<input type="radio"/>	<input type="radio"/>	-	-
	Motion (setting on site)	<input type="radio"/>	<input type="radio"/>	-	-
	Motion COM (setting on site)	-	<input type="radio"/>	-	-
	Motion P (set in the bottom of the pole)	<input type="radio"/>	<input type="radio"/>	<input type="radio"/>	<input type="radio"/>
	POLEDRIVE (set in the bottom of the pole)	<input type="radio"/>	<input type="radio"/>	<input type="radio"/>	<input type="radio"/>

(1) Backlight shield optional except for EPD, EPG, ECa
 (2) Preconfigured communicating system: Wired Sensor Ready type driver and Zhaga consortium base
 * only on versions with 1 or 2 x BLS 8 and by factory programming

Glossary:
 Standard Option - Not available

E/L/P: Lighting/Luminance/Projection, **R/C/T/F/P:** Road/Circulation/Path/Beam/Pedestrian walkway, **E/S/L/A/D/G:** Narrow/Standard/Wide/Asymmetric/Right/Left, **POLEDRIVE:** preset at the bottom of the pole / night dimming calculator with 2 configurable thresholds, set in the bottom of the pole, **Dimming 5:** night dimming calculator with 5 configurable thresholds, **Motion:** moving sensor, **Motion P:** Configurable offset presence detector at the foot of the pole, **Motion DALI:** Detector integrated to the luminaire, adjustable at pole base, **Motion 5:** Motion sensor and dimming calculator, **Motion COM:** Wireless detection and communication, **DALI:** compatible with the DALI protocol, **CLO:** Constant Lumen Output option

BACKLIGHT SHIELD

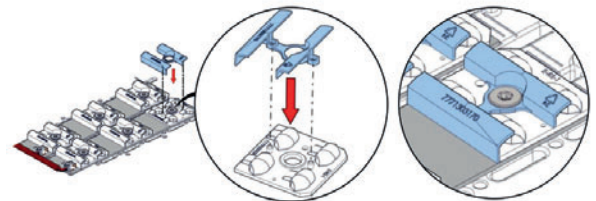

Backlight shield BLS version

MAINTENANCE

Lighting equipment maintenance

Direct access to the equipment after removal of the cover attached by 4 trapped screws {1}. Removable circuit board.

Source maintenance

A second waterproof compartment houses the optical system. Removal of the **PADLED** attached by 3 trapped screws. {2, 3} Electrical disconnection. Removal of the **PADLED** module.



LED Luminaires

Modern Streetfurniture

Waste bins

Bollards Light

tree grill

Bollards

Classic poles cast iron

Steel poles

MODERN POLES CAST IRON

Defence bollards

Drinking water fountain

SEATING

TRAMWAY POLES

Modern LED luminaires

Classic luminaires

Classic street furniture

Ghm

Rue Antoine Durenne
52220 Sommevoire
France
Tel nr. 0033 3 25 55 23 03

ECLATEC

41 rue Lafayette
54320 Maxeville
France
Tel nr. 0033 3 83 39 38 28

Export internet : www.ghm-eclatec.com

Email export: info@ghm-eclatec.com