



STANZA

Luminaire design: Christophe Canadell

STANZA was born of a desire to rejuvenate, but without betraying, the silhouette of the 4-sided luminaires of yesteryear.

The happy union of the materials gives this luminaire a magic touch that will reveal the charms and secrets of the old cities. And in more modern settings, **STANZA** hints at the mystery of a city that is familiar and welcoming yet also forward-looking.

STANZA is available in both top-mounted and suspended configurations, and there are several variants. In its LED version, it comes with a SOMLED 1 module or BLS type LED strips.



INTEGRATED BLS STRIPS



SOMLED 1 MODULE



Stanza Festone



STANZA



APPLICATIONS

- Mounting: Post top or suspended
- Recommended heights: 4 to 8 m
- Urban streets, pedestrians, cycle paths, squares

DESCRIPTION

- Injection die-cast aluminium body
- Arms in polycarbonate (UV treatment)
- Thermally toughened flat glass
- According to the version, injected aluminium arms and carrying structure
- Polyester powder coating, any colour available
- IP 66
- IK 10
- Luminaire pre-wired in the factory (6 m) (post top version only)
- Class I or II
- 2 types of sources:

SOMLED 1 module:

- colour temperature: 4000 K and 3000 K

BLS strips:

- equipped with BLS with QUADRALENS lenses
- colour temperature: 2400 K, 2700 K, 3000 K or 4000 K

CITIZEN REFERENCE POINTS

- Materials used: Aluminium 68%, Plastic 12%, Steel 9%, Glass 7%, Other 4%
- Complies with the RoHS directive
- High recyclability rate

WATERPROOFING

- IP 66 waterproofing in accordance with the standard EN 60 529
- Extruded silicone gasket - high temperature on the body and glass
- Breathing system with activated carbon filter

MECHANICAL INTERFACES

- Post top luminaire:
Fixation on standard pole Ø 60/62 mm
For pole Ø 76 mm top, optional spigot C (see page 278)
Post top mounted, fastened by 8 screws (M8)
- Suspended luminaire:
Suspended fixation with gas threaded swivel joint Ø 27 (see page 278 - H)

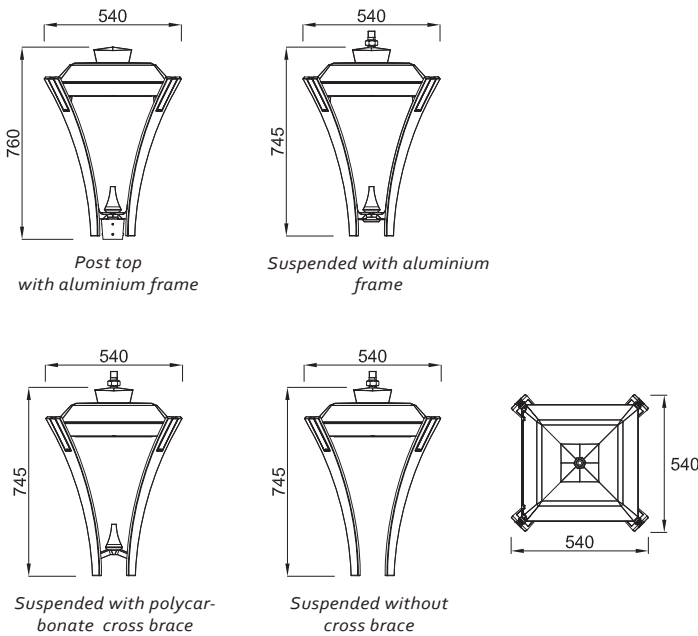

SOMLED 1 - ERS (post top version)

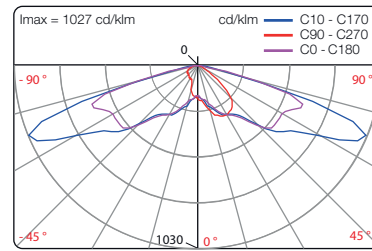

SOMLED 1 - ERL (post top version)

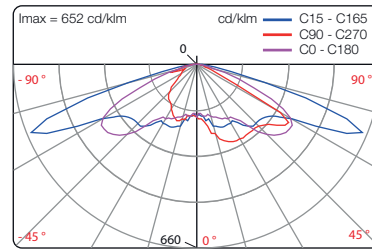

KEY POINTS

| | | STANZA |
|---|---|---|
| Applications | | Urban streets, pedestrians, cycle paths, squares |
| Recommended heights | | 4 to 10 m |
| Mounting | | Post top or suspended |
| Dimensions | Length | 540 mm |
| | width | 540 mm |
| | height | 745 mm |
| Weight | | suspended with/without cross brace: 16 kg suspended with aluminium frame: 18 kg Post top: 18,5 kg |
| Windage area | | suspended without cross brace: 0,14 m ² suspended with cross brace: 0,15 m ² suspended with aluminium frame: 0,15 m ² Post top: 0,15 m ² |
| Sources | | SOMLED 1 |
| | | BLS STRIPS |
| Optics and light distribution options | | SOMLED 1: ECL, ERS, ERL QUADRALENS [®] : ECa, ERS, ERL, LRL, LRS |
| OPTIONS | Backlight shield⁽¹⁾ (factory or site assembly) | ○ |
| | SMART-READY[®] (2) by Eclatec (construction) | ○ |
| | DALI (construction) | ○ |
| | Dimming 5 (preset) | ○ |
| | CLO (preset) | Compatible with standard version or DALI option |
| | Motion 5 (preset) | ○ |
| | Motion (setting on site) | ○ |
| | Motion COM (setting on site) | ○ |
| | Motion P (set in the bottom of the pole) | ○ |
| POLEDRIVE (set in the bottom of the pole) | ○ | |

(1) Backlight shield optional except for EPD, EPG, ECa
(2) Preconfigured communicating system: Wired Sensor Ready type driver and Zhaga consortium base

Glossary:
● Standard ○ Option - Not available

E/L/P: Lighting/Luminance/Projection, **R/C/T/F/P:** Road/Circulation/Path/Beam/Pedestrian walkway, **E/S/L/A/D/G:** Narrow/Standard/Wide/Asymmetric/Right/Left, **POLEDRIVE:** preset at the bottom of the pole / night dimming calculator with 2 configurable thresholds, set in the bottom of the pole, **Dimming 5:** night dimming calculator with 5 configurable thresholds, **Motion:** moving sensor, **Motion P:** Configurable offset presence detector at the foot of the pole, **Motion DALI:** Detector integrated to the luminaire, adjustable at pole base, **Motion 5:** Motion sensor and dimming calculator, **Motion COM:** Wireless detection and communication, **DALI:** compatible with the DALI protocol, **CLO:** Constant Lumen Output option

BACKLIGHT SHIELD

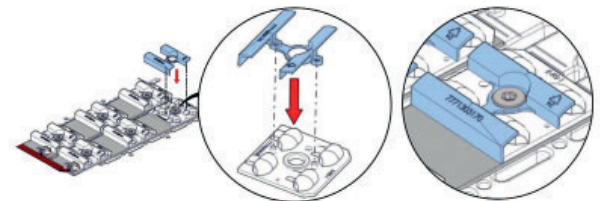

Backlight shield BLS version

MAINTENANCE

Opening and closing

Unlocking of the cover with a flat screwdriver. {1}
Opening of the cover and resting on the safety prop. {2}

Source maintenance

Direct access to the SOMLED 1 module after opening the cover. {3}
Power supply by quick connectors. Removable module.

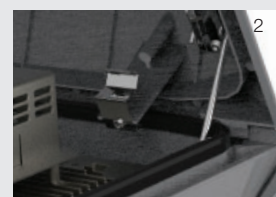



ECLATEC

led verlichting

banken

afvalbakken

custom made producten

houten lichtmasten

stalen lichtmasten

solar verlichting

lichtzuilen

bandstand

boomroosters

plantenbakken

fietsrekken

klassieke lichtmasten

openbare verlichting

terrein verlichting

afzetzpalen

standbeelden

kunst

bollards

fonteinen

Auteursrechten en intellectuele eigendomsrechten

Het auteursrecht op deze brochure berust bij GHM Eclatec B.V. of bij derden (GHM SA en Eclatec SAS) welke met toestemming dit (beeld) materiaal beschikbaar hebben gesteld aan GHM Eclatec B.V. Vermenigvuldiging in wat voor vorm dan ook is alleen toegestaan na voorafgaande toestemming door GHM Eclatec B.V.

Copyright © 2019 GHM Eclatec BV.

Foto credits: ©Eclatec, ©Fotolia, ©Shutterstock, ©GHM

Alle rechten voorbehouden

GHM Eclatec BV Tinstraat 91 2984 AN Ridderkerk 0031 (180) 745043
info@ghm-eclatec.nl www.ghm-eclatec.nl KVK Rotterdam 53536991

Onderdeel van Agora Technologies