



SONATA

Luminaire design: ECLATEC

Primarily designed for bracket mounting on facades, **SONATA** has been designed like a light and discrete partition. Its lines, elusive and slender, melt with discretion into various urban scenario's. **SONATA** excels in narrow streets, mounted on brackets and thus without impact on pedestrian routes, **SONATA** lights roadways up to 9 metres wide.

SONATA is equipped with an integrated connection box and a reversible mounting base which adapts to various connection cases and therefore avoids ugly electrical connections.

Optionally, the upper face of **SONATA** can accept a retro-lighting module for facades, controlled by an astronomical clock where necessary, so as to comply with nocturnal shutoff regulations without requiring double cabling.

The **SONATA** luminaire is also suitable for pole mounting with an original mounting extending the pole upwards for 1 to 3 superimposed lights.



INTEGRATED BLS STRIPS



BACKLIGHTING



Sonata Top



Sonata with detector



Sonata O (backlighting)



SONATA wall-mounted



SONATA wall-mounted O



SONATA top



APPLICATIONS

- Mounting: wall-mounted, top
- Urban streets, pedestrian routes, cycle paths, residential lighting, town-centre, architectural emphasis
- Recommended heights: 4 to 6 m

DESCRIPTION

- Body, canopy and plate made of injected die-cast aluminium
- Silkscreen printed, thermally toughened flat glass
- Polyester powder coating, any colour available
- IP 66 / IK 10 / Class I or II
- Convertible wall-mounted plate for guiding cable from above or from the underside
- Standard BLS LED strips equipped with **QUADRALENS** lenses
- Colour temperature: 2400 K, 2700 K, 3000 K or 4000 K
- Option: protective device against overcurrent and short circuits and / or integrated fuse holder in the luminaire

BACKLIGHTING (VERSION O)

- op-mounted RGBW LED in the luminaire cover, adjustable from 0° to 10° with external setting.
- PC bowl
- Narrow or wide beam with ORALENS lenses
- Externally adjustable optical unit for more precise adjustment
- DMX control (through wiring with 2 extra dedicated cable glands), multitude of colours and variations
- Dedicated power supply: backlighting switched off programmatically (cf. decree of 25 January 2013 relating to the night lighting of non-residential buildings)

CITIZEN REFERENCE POINTS

- Materials used: Aluminium 65%, Other 16%, Glass 10%, Steel 8%, Plastic 1%
- Complies with the RoHS directive
- High recyclability rate

WATERPROOFING



- IP 66 waterproofing in accordance with the standard EN 60 529
- Extruded silicone gasket
- 2 anchored cable glands (through wiring possible)
- Breathing system with activated carbon filter

MECHANICAL INTERFACES

- {1} Wall-mounted bracket: 4 holes \varnothing 12 space between centers 180 mm x 140 mm
 - Tilt 0°, 2.5°, 5°, 7.5° and 10°
 - Luminaire tilted at 2°
- {2} Post top version with 1 to 3 arms: male bracket fastening \varnothing 60/ \varnothing 62 mm (see page 278)
 - Tilt 7°

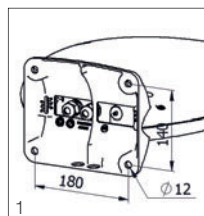

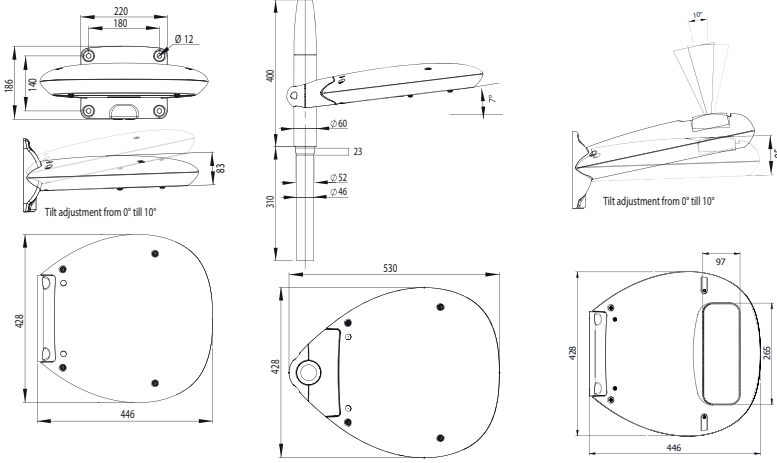

PHOTOMETRIC DISTRIBUTIONS

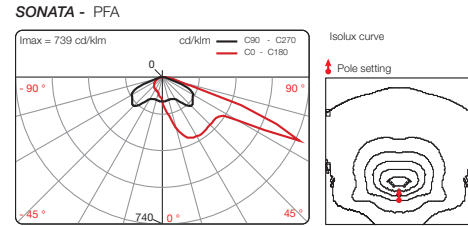
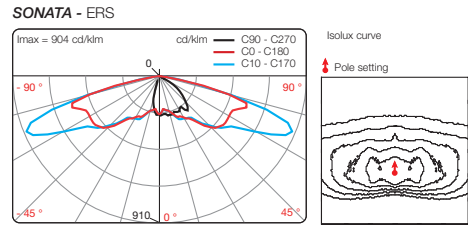
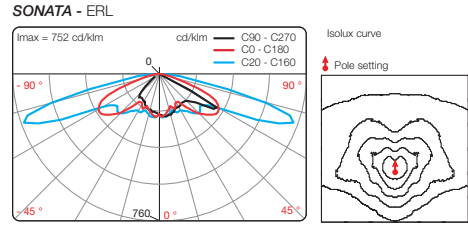

KEY POINTS

		SONATA	SONATA O
Applications		Urban streets, pedestrian routes, cycle paths, residential lighting, town-centre Only Sonata O: architectural emphasis	
Recommended heights		4 to 6 m	
Mounting		Top fixation 1 to 3 arms and wall-mounted bracket	wall-mounted bracket
Dimensions	Length	446 mm	446 mm
	width	428 mm	428 mm
	height	83 mm	95 mm
Weight		7,5 kg	
Windage area		0,05 m ²	
Sources		BLS strips	BLS strips + RGBW LED adjustable façade backlighting
Sources access		Direct access to the gear by removing the canopy fixed with 4 high-helix lead screws	Direct access to power units after removing cover fastened by 4 captive high helix screws
Optics and light distribution options		QUADRALENS ⁽¹⁾ : ERS, ERL, ECa, ERE, LRS, LRL, PFA, EPD, EPG, ETS	QUADRALENS ⁽¹⁾ : ERS, ERL, ECa, ERE, LRS, LRL, PFA, EPD, EPG, ETS Backlighting: PFI, PFM, PFL
OPTIONS	BACKLIGHTING	-	○
	Backlight shield⁽¹⁾ (factory or site assembly)	○	○
	SMART-READY[®] (2) by Eclatec (construction)	○	○
	DALI (construction)	○	○
	Dimming 5 (preset)	○	○
	CLO (preset)	Compatible with standard version, Dimming 5, Motion 5 or DALI option	Compatible with standard version, Dimming 5 or DALI option
	Motion 5 (preset)	○	-
	Motion (setting on site)	○	-
	Motion COM (setting on site)	○	-
	Motion P (set in the bottom of the pole)	○	○
Motion DALI (set in the bottom of the pole)	○	-	
POLEDRIVE (set in the bottom of the pole)	○*	○*	

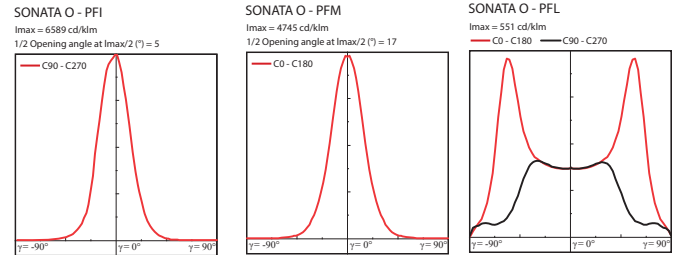

BACKLIGHT SHIELD

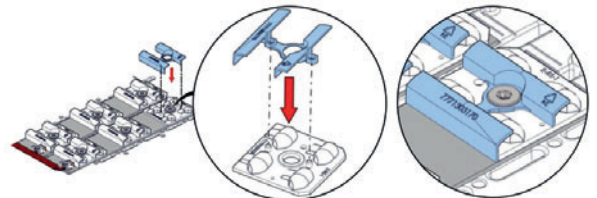

Backlight shield BLS version

MAINTENANCE

Lighting equipment maintenance
 Direct access to the gear by removing the canopy fixed with 4 high-helix lead screws

Source maintenance
 Access to BLS strips and lenses after removal of the glass bowl attached with 4 screws.

RGBW retro-lighting module maintenance
 Quick electrical disconnection of the LED module without tools.
 Removable LED module (2 screws).

(1) Backlight shield optional except for EPD, EPG, ECa
 (2) Preconfigured communicating system: Wired Sensor Ready type driver and Zhaga consortium base
 * Pole base option for post top luminaires, inside the luminaire for the wall-mounted version

Glossary:
 ● Standard ○ Option - Not available

E/L/P: Lighting/Luminance/Projection, **R/C/T/F/P:** Road/Circulation/Path/Beam/Pedestrian walkway, **E/S/L/A/D/G:** Narrow/Standard/Wide/Asymmetric/Right/Left, **POLEDRIVE:** preset at the bottom of the pole / night dimming calculator with 2 configurable thresholds, set in the bottom of the pole, **Dimming 5:** night dimming calculator with 5 configurable thresholds, **Motion:** moving sensor, **Motion P:** Configurable offset presence detector at the foot of the pole, **Motion DALI:** Detector integrated to the luminaire, adjustable at pole base, **Motion 5:** Motion sensor and dimming calculator, **Motion COM:** Wireless detection and communication, **DALI:** compatible with the DALI protocol, **CLO:** Constant Lumen Output option



ECLATEC

led verlichting

banken

afvalbakken

custom made producten

houten lichtmasten

stalen lichtmasten

solar verlichting

lichtzuilen

bandstand

boomroosters

plantenbakken

fietsrekken

klassieke lichtmasten

openbare verlichting

terrein verlichting

afzetzpalen

standbeelden

kunst

bollards

fonteinen

Auteursrechten en intellectuele eigendomsrechten

Het auteursrecht op deze brochure berust bij GHM Eclatec B.V. of bij derden (GHM SA en Eclatec SAS) welke met toestemming dit (beeld) materiaal beschikbaar hebben gesteld aan GHM Eclatec B.V. Vermenigvuldiging in wat voor vorm dan ook is alleen toegestaan na voorafgaande toestemming door GHM Eclatec B.V.

Copyright © 2019 GHM Eclatec BV.

Foto credits: ©Eclatec, ©Fotolia, ©Shutterstock, ©GHM

Alle rechten voorbehouden

GHM Eclatec BV Tinstraat 91 2984 AN Ridderkerk 0031 (180) 745043
info@ghm-eclatec.nl www.ghm-eclatec.nl KVK Rotterdam 53536991

Onderdeel van Agora Technologies