



IXIS

Luminaire design: Eclatec

Half projector, half luminaire, IXIS is located at the crossroads of current architectural trends.

IXIS opens a multitude of possibilities, by way of its flexibility.

This propensity is due to both its design, particularly its integrated adjustment and attachment system, and its multiple optical variations.



INTEGRATED BLS STRIPS





IXIS 1 - Provided with detector



IXIS 2



APPLICATIONS

- Mounting: lateral, post top and suspended
- Recommended heights: Ixis 1: 4 to 6 m / Ixis 2: 6 to 10 m
- Ixis 1: Urban streets, pedestrian routes, cycle paths, residential lighting, car parks, architectural emphasis
- Ixis 2: Roads, secondary urban and inter-urban streets, car parks, architectural emphasis

DESCRIPTION

- Luminaire available in 2 sizes: Ixis 1 and Ixis 2
- Injection die-cast aluminium body
- Toughened flat glass bowl
- Option: luminaire closed with a security screw
- Opens without tools by pressing the push-strip on the top casting
- Polyester powder coating, any colour available
- IP 66
- IK 10
- Class I or II
- Luminaire pre-wired in the factory (6 m)
- Standard BLS LED strips equipped with **QUADRALENS** lenses
- Colour temperature: 4000 K and 3000K

CITIZEN REFERENCE POINTS

- Materials used:
 - Ixis 1: Aluminium 77%, Other 3%, Glass 8%, Steel 8%, Plastic 4%
 - Ixis 2: Aluminium 76%, Other 4%, Glass 9%, Steel 6%, Plastic 5%
- Complies with the RoHS directive
- High recyclability rate

WATERPROOFING

- IP 66 waterproofing in accordance with the standard EN 60 529
- Extruded silicone gasket
- Cable gland with anchoring device
- Breathing system with activated carbon filter

MECHANICAL INTERFACES

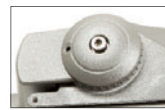

- Angles marking system
- Fitting for mounting on bracket end with external Ø 60 mm (see page 278 - E, F)



- Stirrup mounting bracket made of steel, suspended or top mounted on adjustable brackets

LIGHTING OF PEDESTRIAN CROSSINGS

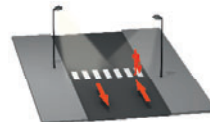

- **EPD: pedestrian crossing lighting Right**
Luminaire placed upstream of the crossing section, in the moving traffic direction, for a two-way street application



- **EPG: pedestrian crossing lighting Left**
Luminaire in addition to EPD, placed upstream of the crossing section, for wide one-way street application

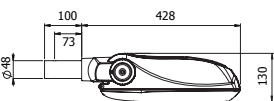
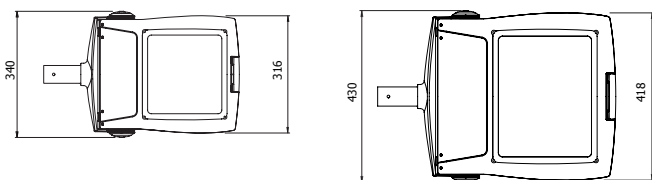

IXIS 1 - Decorative U-bracket in aluminium

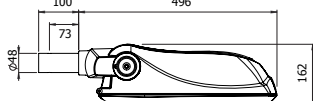

IXIS 2 - Decorative U-bracket in aluminium

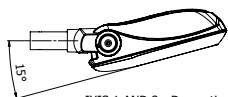

IXIS 1 AND 2 - Decorative U-bracket adjustment

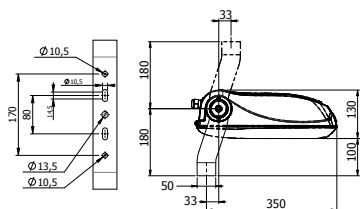

IXIS 1 - Galvanised steel stirrup bracket

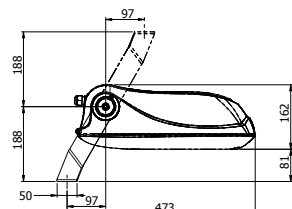

IXIS 2 - Galvanised steel stirrup bracket

KEY POINTS

		IXIS 1	IXIS 2
Applications		Urban streets, pedestrian routes, cycle paths, residential lighting, car parks, architectural emphasis	Roads, secondary urban and inter-urban streets, car parks, architectural emphasis
Recommended heights		4 to 6 m	6 to 10 m
Mounting		lateral, post top and suspended	
Dimensions	Length	428 mm	496 mm
	width	316 mm	418 mm
	height	130 mm	162 mm
Weight		8 kg	12 kg
Windage area		0,06 m ²	0,08 m ²
Sources		BLS strips	
Sources access		Opens without tools by pressing the push-strip on the top casting: direct access to the gear Access to the LED bars and lenses by removing the bowl	
Optics and light distribution options		QUADRALENS	
		ERS, ERL, ECa, ERE, LRL, LRS, EPD, EPG, PFA, ETS	ERS, ERL, ECa, ERE, LRL, LRS, PFA
OPTIONS	Backlight shield⁽¹⁾ (factory or site assembly)	○	○
	DALI (construction)	○	○
	Dimming 5 (preset)	○	○
	CLO (preset)	Compatible with standard version, Dimming 5, Motion 5 or DALI option	
	Motion 5 (preset)	○	-
	Motion (setting on site)	○	-
	Motion COM (setting on site)	○	○
	Motion P (set in the bottom of the pole)	○	○
	POLEDRIVE (set in the bottom of the pole)	○	○

(1) Backlight shield optional except for EPD, EPG, ECa, ECb, PSa

Glossary:

● Standard ○ Option - Not available

E/L/P: Lighting/Luminance/Projection, **R/C/T/F/P:** Road/Circulation/Path/Beam/Pedestrian walkway, **E/S/L/A/D/G:** Narrow/Standard/Wide/Asymmetric/Right/Left, **POLEDRIVE:** preset at the bottom of the pole / night diming calculator with 2 configurable thresholds, set in the bottom of the pole, **Dimming 5:** night diming calculator with 5 configurable thresholds, **Motion:** moving sensor, **Motion P:** Configurable offset presence detector at the foot of the pole, **Motion DALI:** Detector integrated to the luminaire, adjustable at pole base, **Motion 5:** Motion sensor and dimming calculator, **Motion COM:** Wireless detection and communication, **DALI:** compatible with the DALI protocol, **CLO:** Constant Lumen Output option

PHOTOMETRIC DISTRIBUTIONS

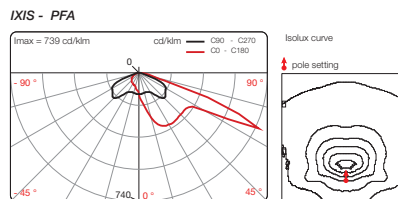
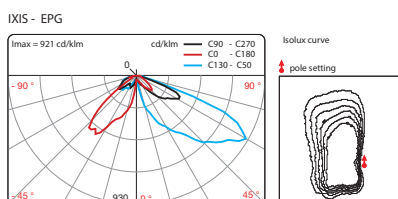
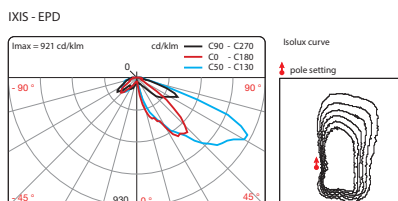
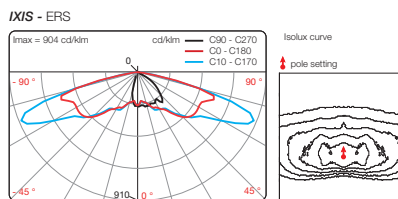
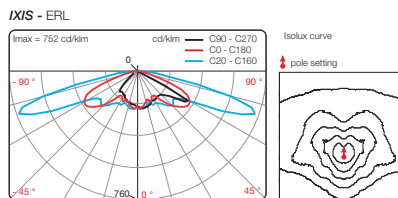

BACKLIGHT SHIELD

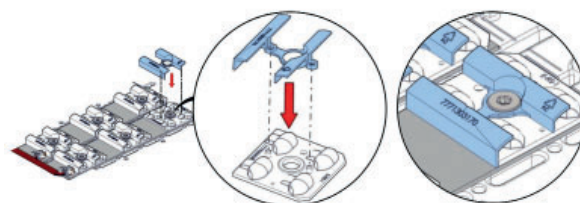

Backlight shield BLS version

MAINTENANCE

Opening and closing

Opens without tools by pressing the paddle on the top cover. Cutting of the power supply when the luminaire is opened. Closure of the luminaire with a security screw as an option.

Lighting equipment maintenance

Quick electrical disconnection without tools. Circuit board removable onsite without tools.

Source maintenance

Access to LED strips and lenses after removal of the glass bowl attached with 4 screws

LED Luminaires

Modern Streetfurniture

Waste bins

Bollards Light

tree grill

Bollards

Classic poles cast iron

Steel poles

MODERN POLES CAST IRON

Defence bollards

Drinkwater fountain

SEATING

TRAMWAY POLES

Modern LED luminaires

Classic luminaires

Classic street furniture

Ghm

Rue Antoine Durenne
52220 Sommevoire
France
Tel nr. 0033 3 25 55 23 03

ECLATEC

41 rue Lafayette
54320 Maxeville
France
Tel nr. 0033 3 83 39 38 28

Export internet : www.ghm-eclatec.com

Email export: info@ghm-eclatec.com